



Reflected Heat Design Inc.

Corp: 418 Highway 8, Stoney Creek, ON L8G 1G2



## CAVEMAN SERIES

### Residential

Low Intensity  
Infrared Tube Heaters  
Single Stage • Two Stage



High Performance  
Fully Featured Low Intensity Infrared Heater

**100% SPECULAR REFLECTOR DESIGN**

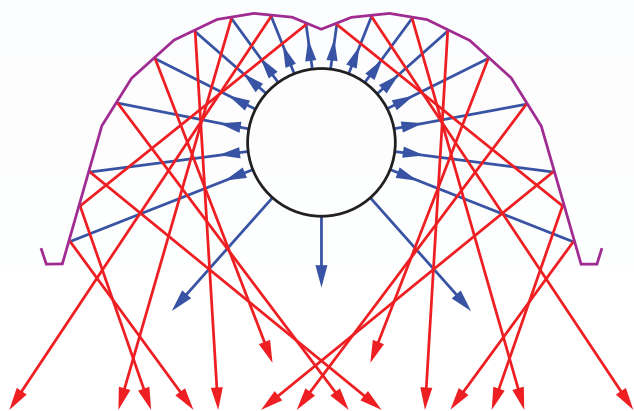

**DECORATIVE GRILL OPTION**



Residential, low intensity infrared heater, whether you're a road warrior, hobbyist or just want the warmest Caveman space in the neighborhood.

- 40 - 60 MBH input, 10 - 30 ft. tube length
- Two Stage gas controls for maximum comfort
- 100% SPECULAR design reflector
- Resilient mounted blower assembly for quiet worry free operation
- Field selectable 24V or 120V operation (single stage)
- 24VAC terminal block connection
- Simple installation
- Low profile burner cabinet
- Zero clearance hanger design available
- Optional - Deco Grill available
- Reliable DSI ignition system c/w post purge
- POTTED ignition module
- Durable powder coat UV resistant paint
- Esthetically pleasing concentric vent kit available

#### Optional Equipment:

- U or L bends for specific layouts
- Side reflector and brackets
- Hot rolled or heat treated aluminized tubes
- Decorative Grill

Model 10-40-NG and 10-60-NG meet NFPA 30A Code for Motor Fuel Dispensing Facilities and Repair Garages. Maximum tube temperature 399°C (750°F)

## Specifications

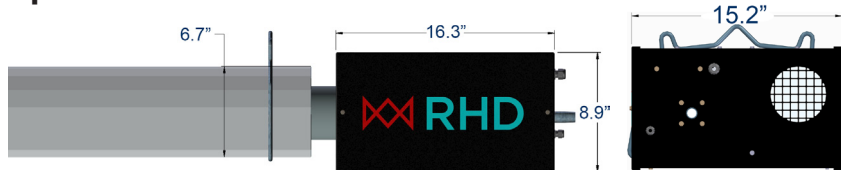

Reflected Heat Design Inc.

Burner Model Single Stage, Two Stage	Burner Rate (Two Stage) High / Low (Btu/hr)	Tube Length (ft)		Elect. / Gas Press. / Tubes
		Min.	Max.	
CV-40*	40,000 / 20,000	10	20	<b>Electrical:</b> 1.6A, 115 VAC <b>Gas Connection:</b> 1/2” MNPT <b>Manifold Pressure:</b> 3.5” / 2.4” W.C. Nat. Gas 10.0” / 6.0” W.C. LP Gas <b>Tube Diameter:</b> 4” <b>Tube Material:</b> Aluminized heat treated, hot rolled, and stainless steel. Tube sections are 5 or 10 feet long.
CV-60*	60,000 / 30,000	15	30	
* Certified for residential use. Other model options available.				

Reflector Orientation	Straight			Straight with Side Shield			45°			U-Tube		
Model	Top	Sides	Bottom	Top	Sides	Bottom	Top	Sides	Bottom	Top	Sides	Bottom
CV-40	2	2	4	4	4	17	47	52	40	35	40	17
CV-60	2	2	4	4	4	4	28	32	16	6	16	4

Dimensions are in inches. Other configurations are available. See installation manual for complete listing of configurations and specifications. Data from the installation manual and the rating plate supercede the information published in the literature.

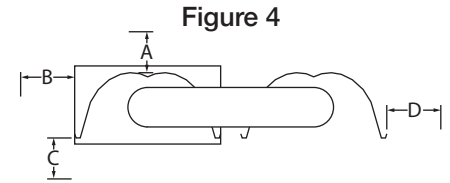
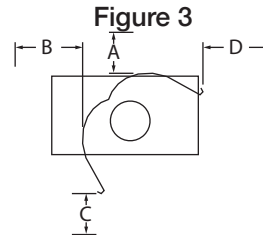
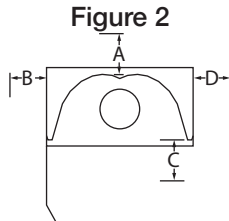
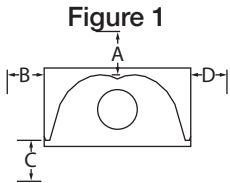

Distributed by:



Hydronic **HVAC**  
Sales  
[www.hydronicvac.com](http://www.hydronicvac.com)

Sales & Technical Support:

Tel (877) 936-4822 (HVAC)

Fax (877) 561-4822 (HVAC)

Email [sales@hydronicvac.com](mailto:sales@hydronicvac.com)