



Reflected Heat Design Inc.

Corp: 418 Highway 8, Stoney Creek, ON L8G 1G2



# INFINITE SERIES

## Low Intensity Infrared Tube Heaters Modulating (50% - 100%)



### High Performance Fully Featured Low Intensity Infrared Heater

#### 100% SPECULAR REFLECTOR DESIGN

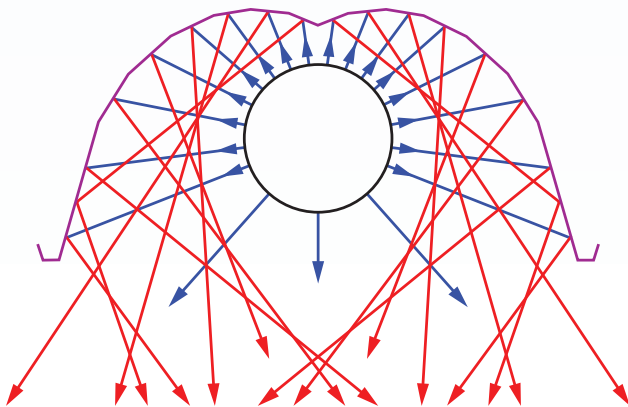

#### OPTIMUM FUEL SAVINGS AND COMFORT

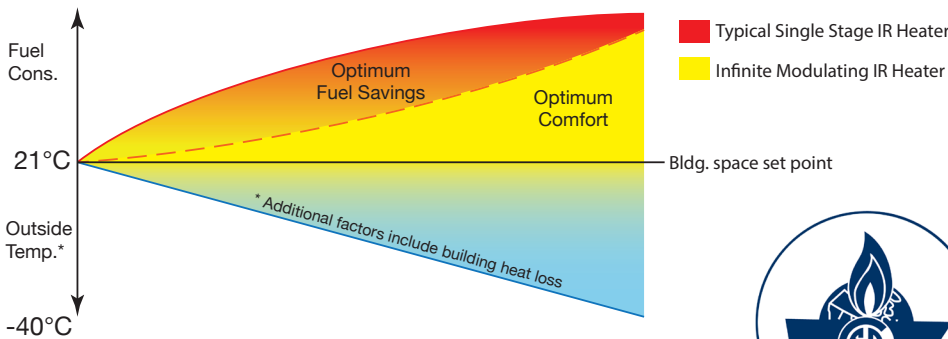

Low intensity Infrared heater that utilizes the best material and crafted for optimum performance.

- 100% SPECULAR design reflector
- 50% to 100% modulating firing range, greatest in the industry
- Electronic modulating burner provides steady state efficiency
- Nickel chrome multi stage burner cup
- BAS ready for 4-20mA or 4-10Vdc analog signal
- 24VAC terminal block connection
- Simple installation
- Low profile burner cabinet
- Zero clearance hanger design
- Extra heavy duty tube coupling
- Reliable DSI ignition system c/w post purge
- Reduced electrical operating cost
- POTTED ignition module
- Durable powder coat UV resistant paint
- PVC Fresh Air Adaptor
- Type 1 flex gas hose
- Visible LED burner "ON" indicator

#### Optional Equipment:

- Side Reflector Kits
- Lower Shield Kit
- U-Tube or Elbow Kits
- Outdoor Operation
- Decorative Grill
- Modulating space thermostat
- Potentiometer signal control for process

Model 10-40-NG and 10-60-NG meet NFPA 30A Code for Motor Fuel Dispensing Facilities and Repair Garages. Maximum tube temperature 399°C (750°F)



# Specifications

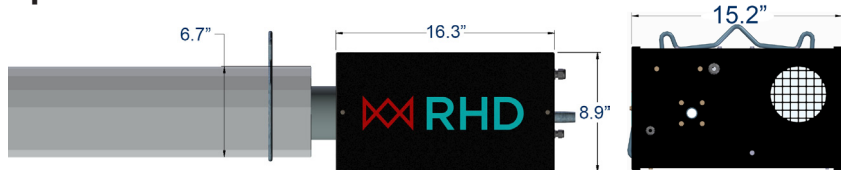

Reflected Heat Design Inc.

Burner Model	Burner Rate Modulating Range Low / Hi (Btu/hr.)	Length (ft)		Elect. / Gas Press. / Tubes
		Minimum	Maximum	
11-40-M-(3)*	20,000 / 40,000	10	20	Electrical: 1.6A, 115 VAC Gas Connection: 1/2" FNPT Manifold Pressure: 4.5" / 1.4" W.C. Nat. Gas 10.0" / 4.0" W.C. LP Gas 4-10 Vdc control signal, variable resistor, or two stage control Tube Diameter: 4" Tube Material: Aluminized heat treated, hot rolled, and stainless steel. Tube sections are 10 feet long.
11-40-M-NG*	20,000 / 40,000	20	30	
11-60-M-(3)*	30,000 / 60,000	15	20	
11-60-M-NG*	30,000 / 60,000	30	40	
11-80-M-(3)	40,000 / 80,000	20	30	
11-100-M-(3)	50,000 / 100,000	20	30	
11-125-M-(3)	62,500 / 125,000	30	40	
11-150-M-(3)	75,000 / 150,000	40	50	
11-175-M-(3)	87,500 / 175,000	40	60	
11-200-M-(3)	100,000 / 200,000	50	70	

\* Certified for residential use.

Burner Model	Dimension A				Dimension B				Dimension C				Dimension D				
	Figure	1	2	3	4	1	2	3	4	1	2	3	4	1	2	3	4
11-40-M-(3)	2	2	4	2	17	4	4	17	47	52	40	47	17	35	40	17	
11-40-M-NG	2	2	4	2	4	2	4	4	28	32	16	29	4	6	16	4	
11-60-M-(3)	2	2	4	2	24	4	4	24	60	58	51	59	24	38	47	24	
11-60-M-NG	2	2	4	2	6	4	4	6	36	36	22	39	6	8	22	6	
11-80-M-(3)	2	2	4	2	26	4	4	28	62	65	58	66	26	44	51	28	
11-100-M(3)	4	4	4	4	30	4	4	31	65	72	68	73	30	46	60	31	
11-125-M-(3)	4	4	6	4	32	4	4	33	70	77	71	78	32	50	64	33	
11-150-M-(3)	6	6	6	6	35	4	4	37	72	80	72	82	35	53	65	37	
11-175-M-(3)	6	6	8	6	40	4	4	40	80	82	75	83	40	55	68	40	
11-200-M-(3)	6	6	8	6	43	6	4	46	84	84	78	85	43	58	72	46	

Dimensions are in inches. Other configurations are available. See installation manual for complete listing of configurations and specifications. Data from the installation manual and the rating plate supercede the information published in the literature.

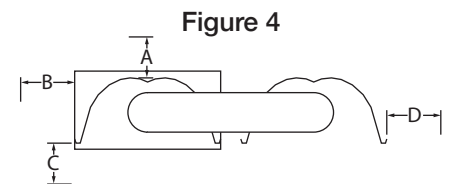
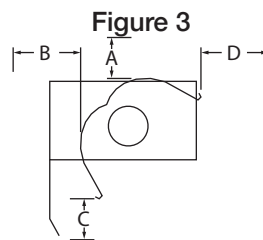
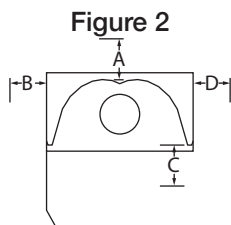
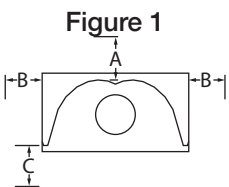

Distributed by:



Hydronic HVAC Sales

[www.hydrnichvac.com](http://www.hydrnichvac.com)

Sales & Technical Support:

Tel (877) 936-4822 (HVAC)

Fax (877) 561-4822 (HVAC)

Email [sales@hydrnichvac.com](mailto:sales@hydrnichvac.com)